



## MAGIC MOVE

- Full extension, fully synchronized runner
- 40kg load capacity
- Zinc plated finish
- Drawer system self locks once positioned on slide
- Soft closing
- Bottom mounting
- 3D adjustment
- Includes 3D front brackets with runners

Nominal Length	Magic Move
250 mm	DTCTS10250H
300 mm	DTCTS10300H
350 mm	DTCTS10350H
400 mm	DTCTS10400H
450 mm	DTCTS10450H
500 mm	DTCTS10500H
550 mm	DTCTS10550H
600 mm	DTCTS10600H

## features

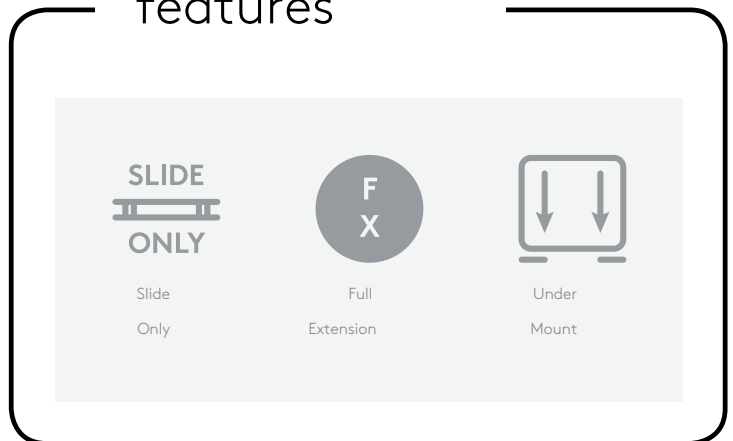

## advantages

- 3D adjustable for a better retro-fitting of drawers
- Soft closing without additional parts
- Fully concealed runner
- No rebate required to accommodate runner

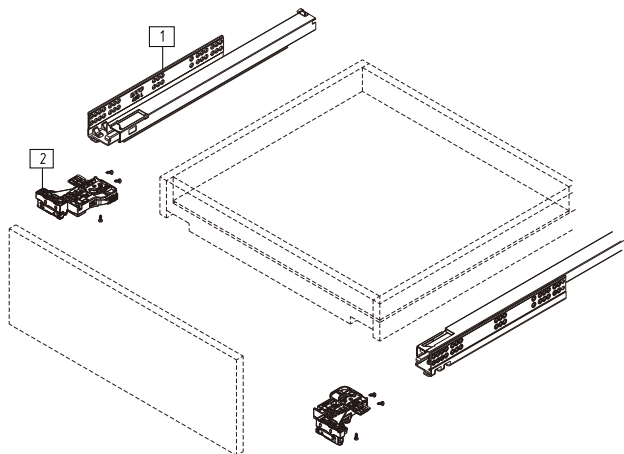

## Installation dimensions

NL=Nominal Slide Length  
 LT=Internal Cabinet Depth  
 LT=NL+3

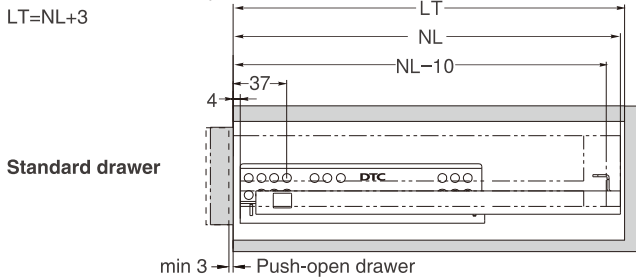

Standard drawer

NL=Nominal Slide Length  
 LT=Internal Cabinet Depth  
 LT=NL+21

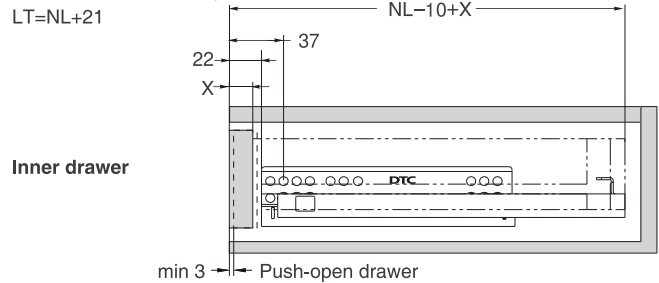

Inner drawer

## Screw position of the slides (mm)

Cabinet edge	Slide Length (L)	Slide Length (NL)
	250 L	250
	270 L	270
	300 L	300
	320 L	320
	350 L	350
	380 L	380
	400 L	400
	420 L	420
	450 L	450
	480 L	480
	500 L	500
	520 L	520
	550 L	550
	600 L	600

Slide Length (L)	Slide Length (NL)
32	32
96	96
128	128
160	160
192	192
224	224
256	256

37 ← Fourth hole

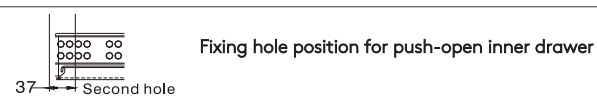

## Installation dimensions

SKW= Internal Drawer Width  
 LW= Internal Cabinet Width

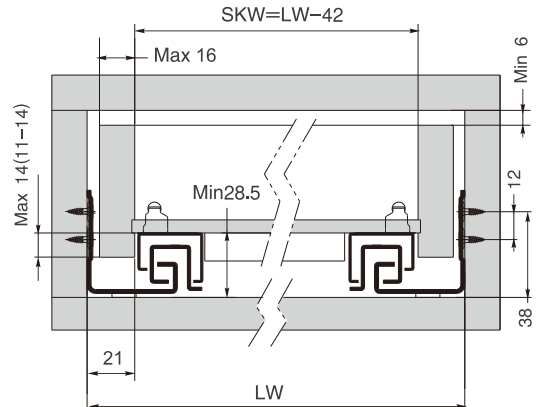

## Drawer back preparation (mm)

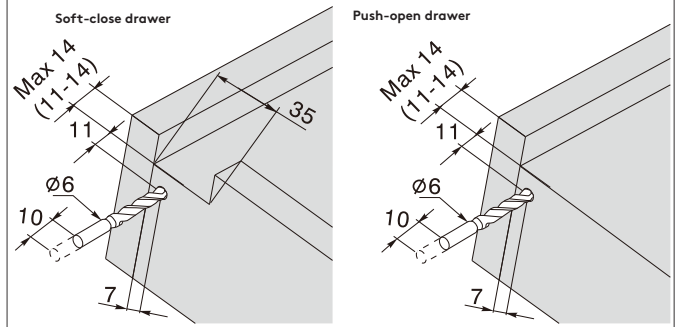

## Locking device installation (mm)

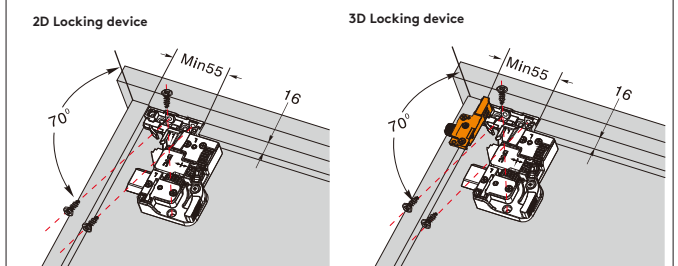

## Drawer Assembly with 3D Adjustment Locking Device

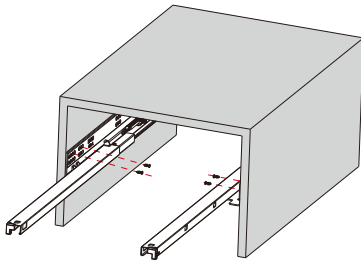

Fix the slide on the cabinet.

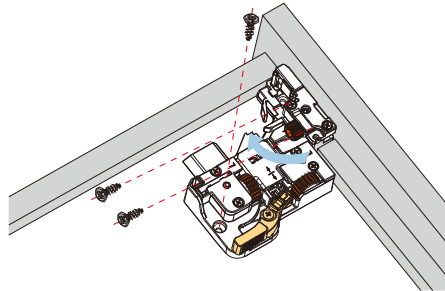

Move out the adjusting part and fix the locking device on the drawer bottom. Put the adjusting part back and tighten the screws.

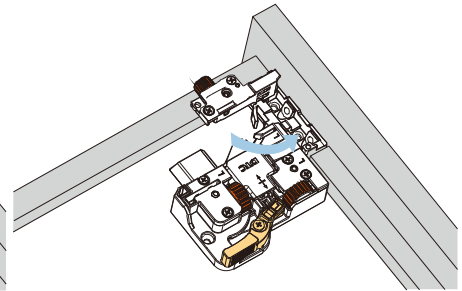

## Drawer Assembly with 3D Adjustment Locking Device

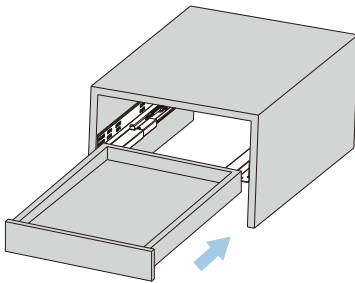

Lay the drawer bottom onto the slide then push the drawer into the cabinet.

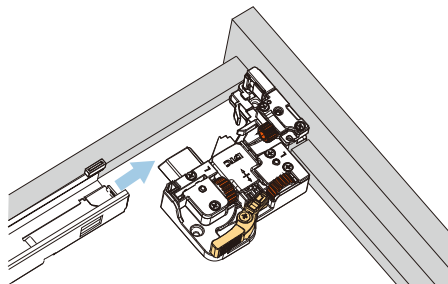

## Adjustment

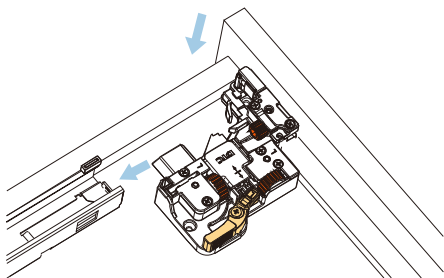

Up & down adjustment

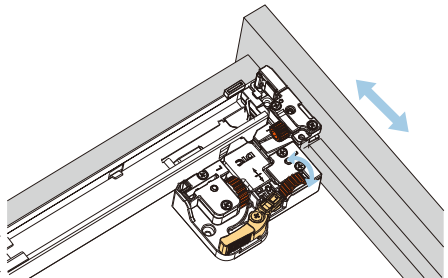

Side adjustment

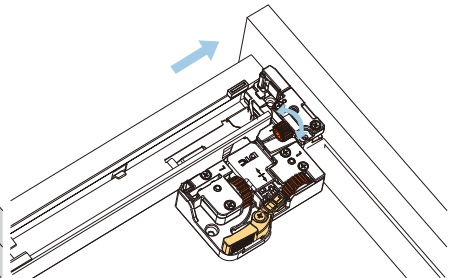

Depth adjustment

## Removal

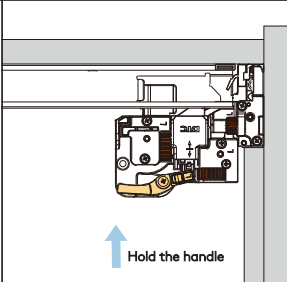

Pull-out

Hold the handle

